

FEATURES

- Low Supply Voltage 1.0V and 1.2V
- Low Current Consumption
- Miniature Packages Available

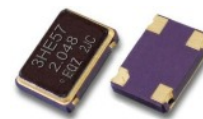

ELECTRICAL SPECIFICATION

Model Number	XU Series								
Output Logic	CMOS								
Supply Voltage V_{DD}	1.0V±5%				1.2V±5%				
Frequency Range	0.625 ~ 50.0MHz								
Current Consumption	1.0mA (typ.); 3.0mA (max.)				1.3mA (typ.); 3.0mA (max.)				
Logic High "1" (90% of V_{DD} min.)	0.8V				0.96V				
Logic Low "0" (10% of V_{DD} max)	0.2V				0.24V				
Rise/Fall Time (Tr) (Measured between 20% ~ 80% of V_{DD})	8.0ns max.				6ns max.				
Load	15pF								
Start-up Time	0.8ms (typ.); 5.0msec (max.)								
Duty Cycle	50%±5%								
Enable/Disable	Enable: 5.0ms (max.); Disable: 100ns (max.)								
Storage Temperature	-55°C to +150°C								
Aging (Ta = 25°C)	±3ppm (max.) first year								
RMS Jitter (12kHz~20MHz)	0.75ps (typ.)								
SSB Phase Noise	Offset	10Hz	100Hz	1kHz	10kHz	100kHz	1MHz	5MHz	20MHz
25.000MHz (1.0V)	dBc/Hz (typ.)	-75	-107	-128	-138	-141	-149	-153	---
50.000MHz (1.2V)	dBc/Hz (typ.)	-83	-112	-136	-140	-147	-155	-155	-156

OPERATING TEMPERATURE RANGE

Frequency Stability Codes	Frequency Stability over Operating Temperature Range	±25ppm	±50ppm	±100ppm
	Commercial (-10° ~ +70°C)	A	B	C
	Industrial (-40° to +85°C)	D	E	F

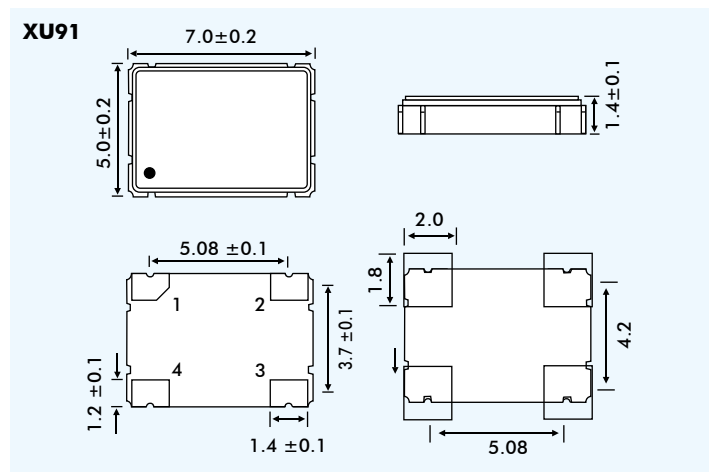
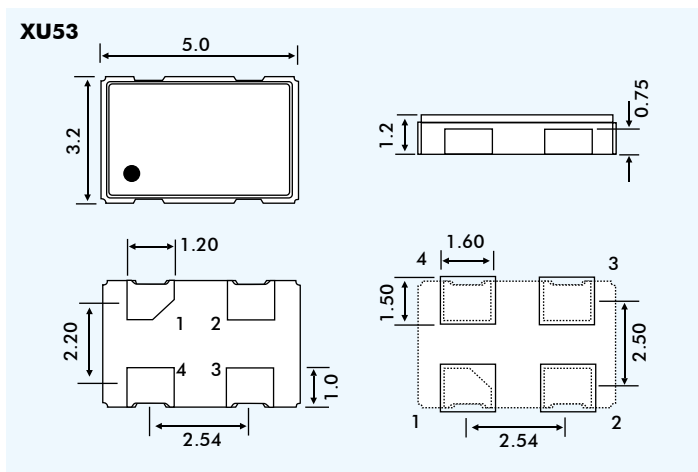
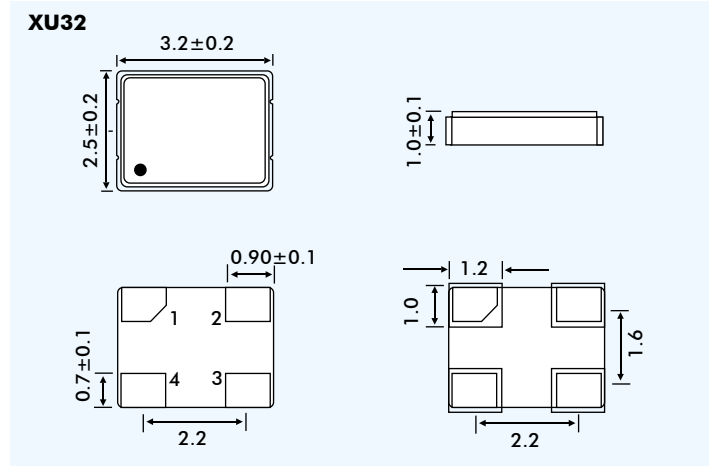
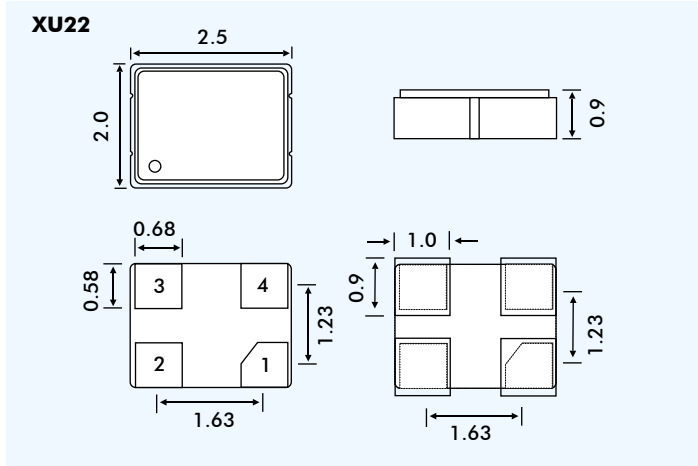
OUTLINE & DIMENSIONS



Pad Connections

- 1 Enable/Disable
- 2 Ground
- 3 Output
- 4 Supply Voltage

ORDERING/PART NUMBER GENERATION

